

S.R. 706 INDIANTOWN ROAD

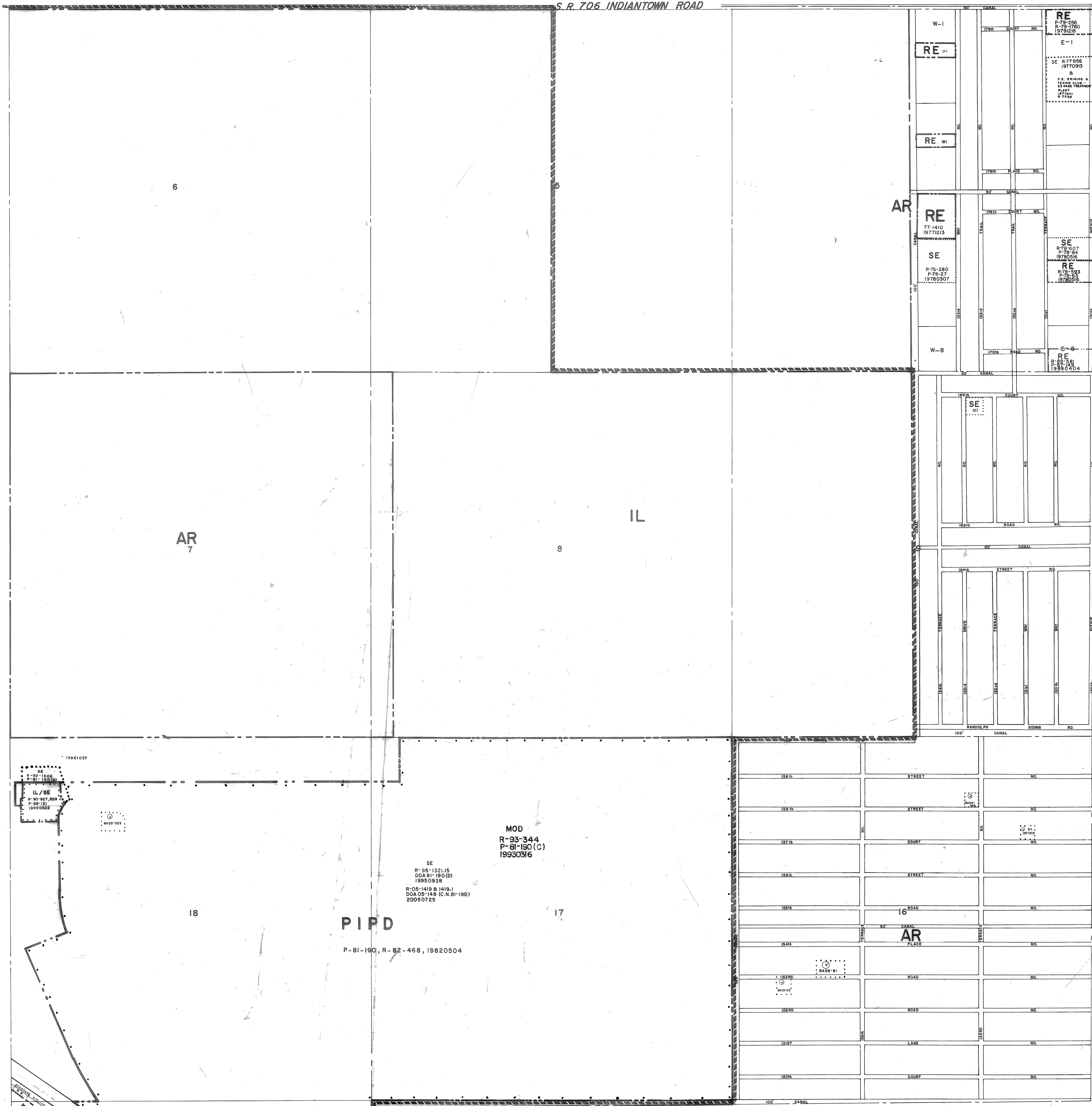

12921027  
IL/SE  
R-30-827,828  
P-81-190  
1990002

MOD  
R-93-344  
P-81-190(C)  
19930316  
SE  
R-58-132115  
D08-81-190(D)  
19950928  
R-05-1419 B (419.1)  
D08-05-148 (C.N.81-190)  
20050725

PIPD  
P-81-190, R-82-468, 19820504

W-1  
RE (1)  
RE (2)  
RE  
77-1410  
19771213  
SE  
R-75-280  
P-75-27  
19780307  
W-8  
RE  
R-75-280  
P-75-27  
19780307  
SE  
R-75-280  
P-75-27  
19780307  
RE  
R-75-280  
P-75-27  
19780307

SE  
R-75-280  
P-75-27  
19780307  
SE  
R-75-280  
P-75-27  
19780307  
SE  
R-75-280  
P-75-27  
19780307  
SE  
R-75-280  
P-75-27  
19780307

1591h STREET NO.  
1581h STREET NO.  
1571h COURT NO.  
1561h STREET NO.  
1551h STREET NO.  
1541h CANAL  
AR PLACE  
1531h ROAD NO.  
1521h ROAD NO.  
1511h LANE NO.  
1501h COURT NO.

RESOLUTIONS	
81	87-810
82	88-84
83	89-85
84	90-86
85	91-87
86	92-88
87	93-89
88	94-90
89	95-91
90	96-92
91	97-93
92	98-94
93	99-95
94	100-96
95	101-97
96	102-98
97	103-99
98	104-100
99	105-101
100	106-102

RT-0  
DISTRICT BOUNDARIES  
CORPORATE BOUNDARIES

B	A
C	D

The zoning category for the property indicated on this sheet may not be consistent with the property's Future Land Use designation under the Palm Beach County Comprehensive Plan. Please contact the Palm Beach County Planning Division at 100 Australian Avenue, West Palm Beach, FL 33406, (561) 233-5500, to confirm the property's Future Land Use designation and other relevant Comprehensive Plan requirements.

**PALM BEACH COUNTY, FLORIDA**  
**OFFICIAL ZONING DISTRICT MAP**  
Scale 1" = 600' approx. Date 4-1-73  
Quadrant 41-41 B Sheet No. 71